



**6**  
PIECES

**1 1/2"**

↔ 210  
↓ 60  
↗ 130  
mm

## 233 1/2" MNTX/C6

Code U02332514



Assortment with long **IMPACT** socket bits for **TORX®** screws in **ABS** case

DESCRIPTION	ITEM/SIZE	PCS.
Long impact socket bits for TORX® screws	233 1/2 MNTX T30-T40-T45-T50-T55-T60	6



**16**  
PIECES

**1 1/2"**

↔ 210  
↓ 60  
↗ 130  
mm

## 687 1/2" C16

Code U06870100



Assortment with **IMPACT** bits in **ABS** case

DESCRIPTION	ITEM/SIZE	PCS.
Impact bit-holder sockets	685 6 1/2	1
Impact bit-holder sockets	685 8 5/16	1
Impact bits for hexagonal screws - 1/2" connection	687 E 6-7-8-10-12-14	6
Impact bits for TORX® screws - 1/2" connection	687 TX T30-T40-T45-T50-T55	5
Impact bits for PHILLIPS® screws - 5/16" connection	686 PH 2-3-4	3



**6**  
PIECES

**3 4"**

↔ 210  
↓ 60  
↗ 130  
mm

## 688 3/4" MD6

Code U06880010



Assortment with **IMPACT** bits in **ABS** case

DESCRIPTION	ITEM/SIZE	PCS.
Holder for impact bits	685 B 1 7/8	1
Impact bits for hexagonal screws - 7/8" connection	688 E 12-17-19-22-24	5



## Range of bit-holders 685 B and **IMPACT** bits 688

**ANTI-CORROSION AND ANTI-WEAR**

Chrome Molybdenum steel with Manganese phosphating.

**ISO 9227**

**LOCK PIN**

It provides greater hold in comparison to a locking grain.

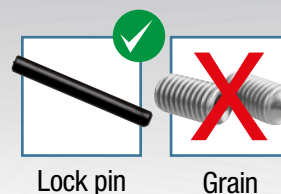

Lock pin

Grain